

ADDENDUM NO. 1

SAP 159-113-018

J7321 Rehabilitation of Assisi DR NW from 16 AVE NW to 14 ST NW

SAP 159-130-008

J7322 Rehabilitation of E Frontage RD HWY 52 NW from Pennington CT NW to 57 ST NW

ISSUED: May 30, 2017

BIDS OPENED AT: 11:00 A.M. on June 6, 2017

YOUR BID MUST ACKNOWLEDGE RECEIPT OF THIS ADDENDUM.

The following additions, corrections, or modifications are hereby made a part of the Contract Documents for the above referenced project.

The Proposal & Plan shall be revised as follows:

PROPOSAL

1. Revise (2232) MILL PAVEMENT SURFACE

s 20.1 The area and depth of milling is shown on the plans

~~Mill Bituminous Surface is paid for the edge mill from 0" to 2" at the curb and gutter.~~

Mill Bituminous Surface is paid for the full (1") mill areas.

Mill Bituminous Surface (2.0") is paid for the full (2") mill areas.

2. Revise Schedule of Prices

Item No.	Description	Units	Quantity
2232.501/00010	MILL BITUMINOUS SURFACE	\$ Y	2,296.00 9,090.00

PLANS

3. **Sheet 2** Est quantity updated

4. **Sheet 3** Table A updated and typical section

5. **Sheet 4-5** Removal hatch updated

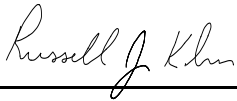

Russ Kelm, PE,

This addendum is 5-pages.

ESTIMATED QUANTITIES										
NOTES	TABLE	SHEET NO.	Item No.	Description	Units	Participating 159-130-008	Non-Participating 159-130-008	Participating 159-113-018	Non-Participating 159-113-018	Total Estimating Quantity
				1 STREET (350)						
			2021.501/00010	MOBILIZATION	LS	0.5		0.5		1
	A, E	3, 11	2104.513/00010	SAWING BITUMINOUS PAVEMENT	LF	531		175		706
3	A	3	2232.501/00010	MILL BITUMINOUS SURFACE (1.0") (P)	S Y	9090				9090
3	A, E	3, 11	2232.501/00050	MILL BITUMINOUS SURFACE (2.0") (P)	S Y	2960		10770		13730
2	B, F	3, 11	2360.501/13200	TYPE SP 9.5 WEARING COURSE MIX (3,B)	TON	1362		913		2275
2	F	11	2360.502/23200	TYPE SP 12.5 NON WEARING COURSE MIX (3,B)	TON			1217		1217
	B	3	2504.602/00032	ADJUST GATE VALVE & BOX	EACH	8				8
	D	11	2506.602/00009	ADJUST FRAME & RING CASTING	EACH			4		4
	B	3	2506.602/00110	ADJUST FRAME & RING CASTING SPECIAL	EACH	3				3
1			2563.601/00010	TRAFFIC CONTROL	LS	0.5		0.5		1
			2565.616/00101	REVISE SIGNAL SYSTEM A	SYS			1.0		1
	C	3	2565.602/61717	SAW CUT LOOP DETECTOR 6" X 6"	EACH	10				10
	C, G	3, 11	2582.501/10000	PAVT MSSG PAINT	S F	1061		30		1091
	C, G	3, 11	2582.502/10104	4" SOLID LINE PAINT	LF	6026		419		6445
	G	11	2582.502/10112	12" SOLID LINE PAINT	LF			180		180
	C, G	3, 11	2582.502/10124	24" SOLID LINE PAINT	LF	78				78
	C, G	3, 11	2582.502/10204	4" BROKEN LINE PAINT	LF	440		770		1210
	C	3	2582.502/10304	4" DOTTED LINE PAINT	LF					0
	C, G	3, 11	2582.502/10404	4" DBLE SOLID LINE PAINT	LF	1392		1964		3356

- 2
1 BITUMINOUS MATERIAL FOR TACKCOAT INCIDENTAL
- 1 THIS ITEM INCLUDES ALL TRAFFIC CONTROL ITEM NECESSARY FOR CONTROL OF TRAFFIC DURING CONTRACTORS OPERATIONS, INCLUDING ASSOCIATED SIGNA AND TRAFFIC CONTROL DEVICES FOR LANE CLOSURES AND FLAGGING OPERATIONS AS NECESSARY. ALL TRAFFIC CONTROL DEVICES SHALL CONFORM TO THE MOST RECENT EDITION OF THE MINNESOTA MANUAL ON UNIFORM TRAFFIC CONTROL DEVICES, INCLUDING "FIELD MANUAL FOR TEMPORARY TRAFFIC CONTROL ZONE LAYOUTS".
- 2
3 BITUMINOUS MATERIAL FOR TACKCOAT INCIDENTAL
(P) PLAN QUANTITY

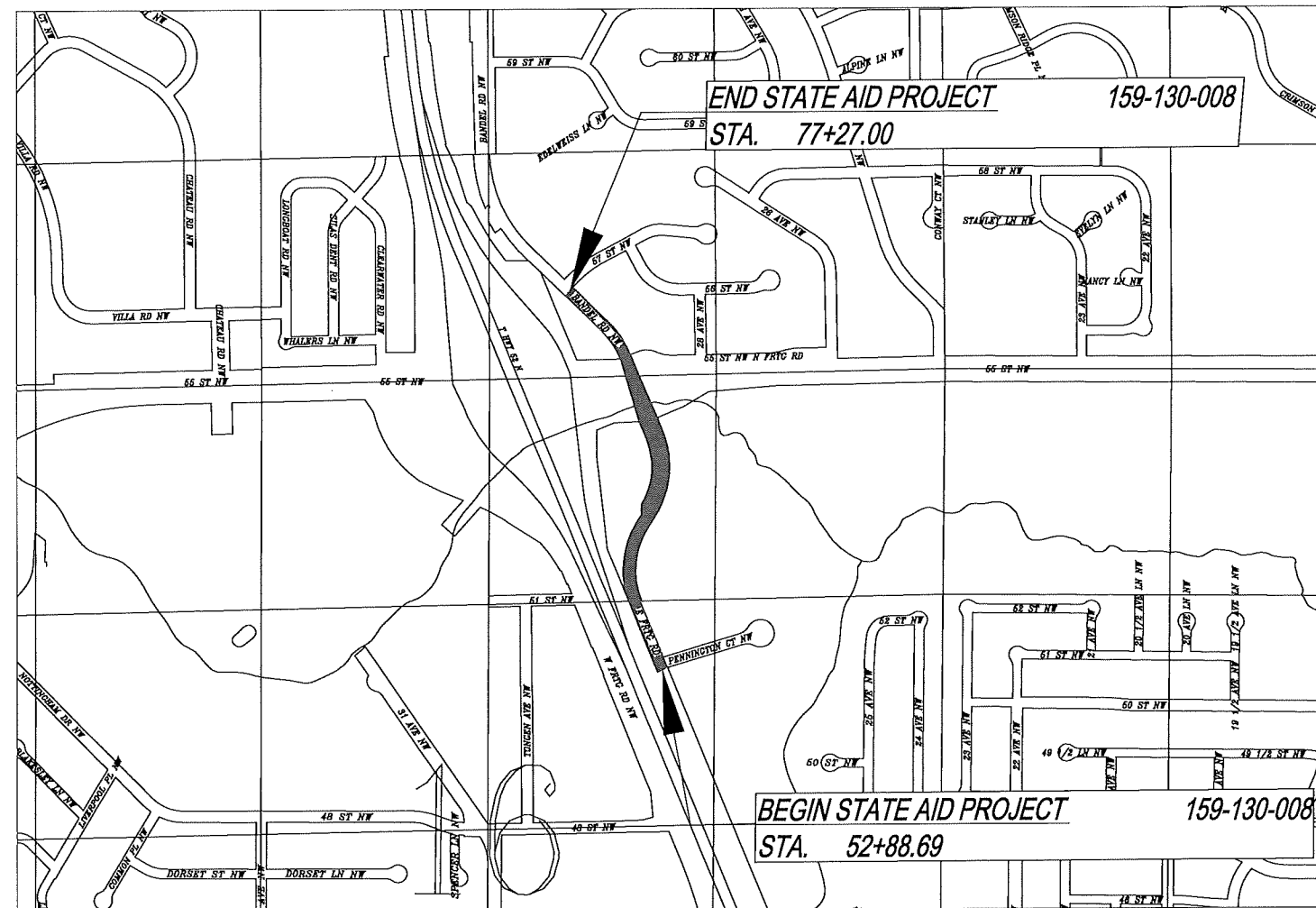

LEGAL DESCRIPTION:
From Center of Section 16 T107 R14 North 923.58' then East 1010.16' to a point of Beginning to a point from SW Cor of SE 1/4 Section 9 T107 R14 North 507.77' then East 460.21' In The City of Rochester, Olmsted County, Minnesota

STANDARD DETAIL PLATES	
CITY OF ROCHESTER	
NO.	DETAIL PLATE
1-07 C	MANHOLE WATERPROOFING
1-11 J	CASTING REFERENCE NUMBERS
1-13 D	STRUCTURE ADJUSTING RINGS
1-16 A	PAVEMENT RESTORATION (CONCRETE & BITUMINOUS STREE)

THE FOLLOWING STANDARD PLATES, APPROVED BY THE FEDERAL HIGHWAY ADMINISTRATION SHALL APPLY ON THIS PROJECT	
STATE OF MINNESOTA	
NO.	DETAIL PLATE
8000J	Channelizers

INDEX TO PLANS	
Sheet Title	Sht. No.
ESTIMATED QUANTITIES	2
TYPICAL SECTIONS	3
DETAILS	2
TABULATIONS	3
REMOVALS	4-6
GRADING	7-9

Revision comment: ADDENDUM #1
Revised: 5-30-17
I hereby certify that this plan was prepared by me or under my direct supervision and that I am a duly Licensed Professional Engineer under the laws of the State of Minnesota.
Russell J. Kline
Date: 4-24-17 Lic. No. 24667

201 4th Street S.E.
Rochester, MN 55904
www.rochestermn.gov/departments/publicworks
Phone: (507) 328-2400 FAX: (507) 328-2401

Department of Public Works
City of Rochester, Minnesota



ESTIMATED QUANTITIES & DETAILS
ON EAST FROTAGE RD. AND BANDEL RD. NW.
FROM PENNINGTON CT. N.W. TO 6TH ST. N.W.

Designer: CNF
Checker: RJK

S.A.P. No. 159-130-008
City Job# J7322
Sheet 2 of 19 Sheets

MILL BITUMINOUS PVMT & SAW CUT BITUMINOUS (A)				
FROM	TO	SAWING BIT. PAVEMENT	MILL BIT. (2" DEPTH)	MILL BIT. (1" DEPTH)
		(LIN FT)	(SQ YD)	(SQ YD)
PENNINGTON CT NW	55TH STREET NW	280.5	552.6	9089.3
55TH STREET NW	57TH STREET NW	249.7	2408.5	
TOTALS		531	2960	9090

BITUMINOUS PAVEMENT (B)				
FROM	TO	ADJUST GATEVALVE & BOX	ADJUST FRAME & CASTING SPECIAL (3)	TYPE SP 9.5 WEARING SPWEA340B (1)(2)
		EACH	EACH	TON
PENNINGTON CT NW	55TH STREET NW	4		1089.5
55TH STREET NW	57TH STREET NW	4	3	272.3
TOTALS		8	3	1362

NOTES:
 (1) QUANTITIES COMPUTED AT A RATE OF 113/LBS/SQ YD/INCH
 (2) TO BE PLACED AT DEPTH OF 2"
 (3) INCLUDES SANITARY MANHOLES

Alignment - Frontage Rd Alignment Data							
NUMBER	STATION	LENGTH	RADIUS	RADIUS CENTER	LINE/CHORD DIRECTION	START POINT	END POINT
L2	52+00.00	478.13			N22° 28' 59.75"W	N=188091.5988 E=608235.5177	N=188533.5485 E=608053.0588
C3	56+78.13	491.46	525.21	N=188733.9724 E=608538.5234	N04° 22' 25.41"E	N=188533.5485 E=608053.0588	N=189005.8941 E=608089.1859
L3	61+69.59	95.22			N31° 10' 50.56"E	N=189005.8941 E=608089.1859	N=189087.3568 E=608138.4840
C4	62+64.81	467.80	500.00	N=189346.2263 E=607710.7147	N04° 22' 39.06"E	N=189087.3568 E=608138.4840	N=189536.9687 E=608172.9023
L4	67+32.62	343.41			N22° 28' 32.44"W	N=189536.9687 E=608172.9023	N=189854.4092 E=608041.8963
L5	70+76.03	143.30			N22° 30' 37.98"W	N=189854.4092 E=608041.8963	N=189986.7892 E=607987.0342
C5	72+19.32	235.78	572.96	N=189787.4294 E=607457.7285	N34° 17' 58.44"W	N=189986.7892 E=607987.0342	N=190180.1972 E=607855.1023
L6	74+55.11	444.89			N46° 05' 18.89"W	N=190180.1972 E=607855.1023	N=190488.7520 E=607534.5943

STRIPING QUANTITIES (C)														
BEGIN LOCATION	END LOCATION	4" DOUBLE SOLID LINE YELLOW	4" SOLID LINE WHITE	4" SOLID LINE YELLOW	4" BROKEN LINE YELLOW	4" BKE LANE DOTTED LINE WHITE	24" SOLID LINE WHITE	CROSSWALK BLOCKING	PVMT MSSG (LEFT ARROW)	PVMT MSSG (RIGHT ARROW)	PVMT MSSG (RIGHT THRU ARROW)	PVMT MSSG (THRU ARROW)	PVMT MSSG (BIKE SYMBOL / ARROW)	SIGNAL LOOPS
		LIN. FT.	LIN. FT.	LIN. FT.	LIN. FT.	LIN. FT.	LIN. FT.	SQ. FT.	SQ. FT.	SQ. FT.	SQ. FT.	SQ. FT.	SQ. FT.	
PENNINGTON CT NW	55TH STREET NW	831	3486	2135	440		44	384	135	15		12		5
55TH STREET NW	57TH STREET NW	561	405				34	432	30		52.32			5
TOTALS		1392	3891	2135	440	0	78	816	165	15	53	12	0	10
			TOTAL	6026								TOTAL	1061	

BASIS FOR MEASUREMENT:
 CROSSWALK BLOCKING - 24 SQ FT/BLOCK
 PAVEMENT MESSAGE (LEFT TURN ARROW) - 15 SQ FT
 PAVEMENT MESSAGE (RIGHT TURN ARROW) - 15 SQ FT
 PAVEMENT MESSAGE (RIGHT THRU ARROW) - 26.16 SQ FT
 PAVEMENT MESSAGE (THRU ARROW) - 12.01 SQ FT
 PAVEMENT MESSAGE (BIKE SYMBOL W/ARROW) - (4')-5.79 (6')-8.69 (8')-11.58 / 4.56 SQ FT

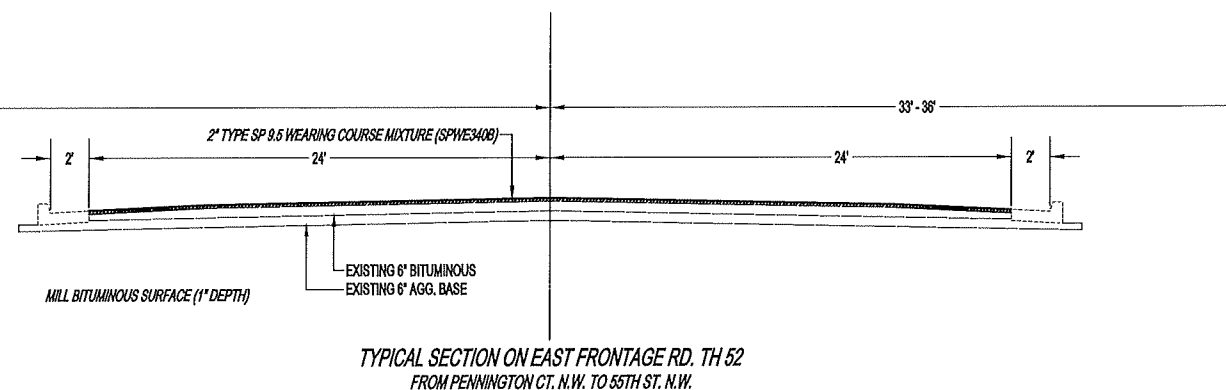
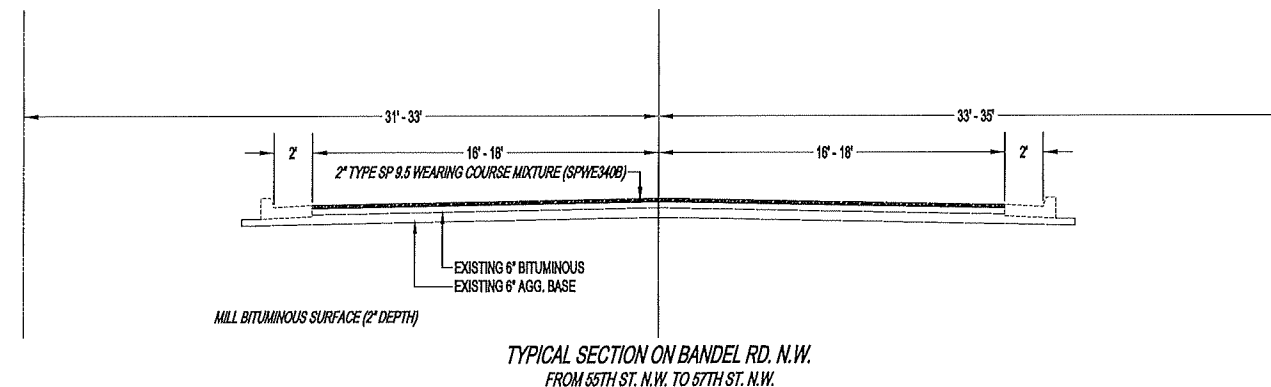

Revision comment: ADDENDUM #1
 Revised: 5-30-17
 I hereby certify that this plan was prepared by me or under my direct supervision and that I am a duly Licensed Professional Engineer under the laws of the State of Minnesota.
 Russell J. Klem Date: 4-24-17 Lic. No. 24667

201 4th Street S.E.
 Rochester, MN 55904
 www.rochestermn.gov/departments/public-works
 Phone: (507) 328-2400 FAX: (507) 328-2407
 Department Of Public Works
 City of Rochester, Minnesota

TYPICAL SECTIONS & CHARTS
 ON EAST FRONTAGE RD. AND BANDEL RD. N.W.
 FROM PENNINGTON CT. N.W. TO 57TH ST. N.W.

Designer: CWF
 Checker: RLK

S.A.P. No. 159-130-008
 City Job# J7322
 Sheet 3 of 19 Sheets

P:\PROJECTS\PROJECTS\7322\Drawings\7322R.dwg, REMOVALS-1, 5/30/2017 3:21:52 PM, cfeime, 1:2

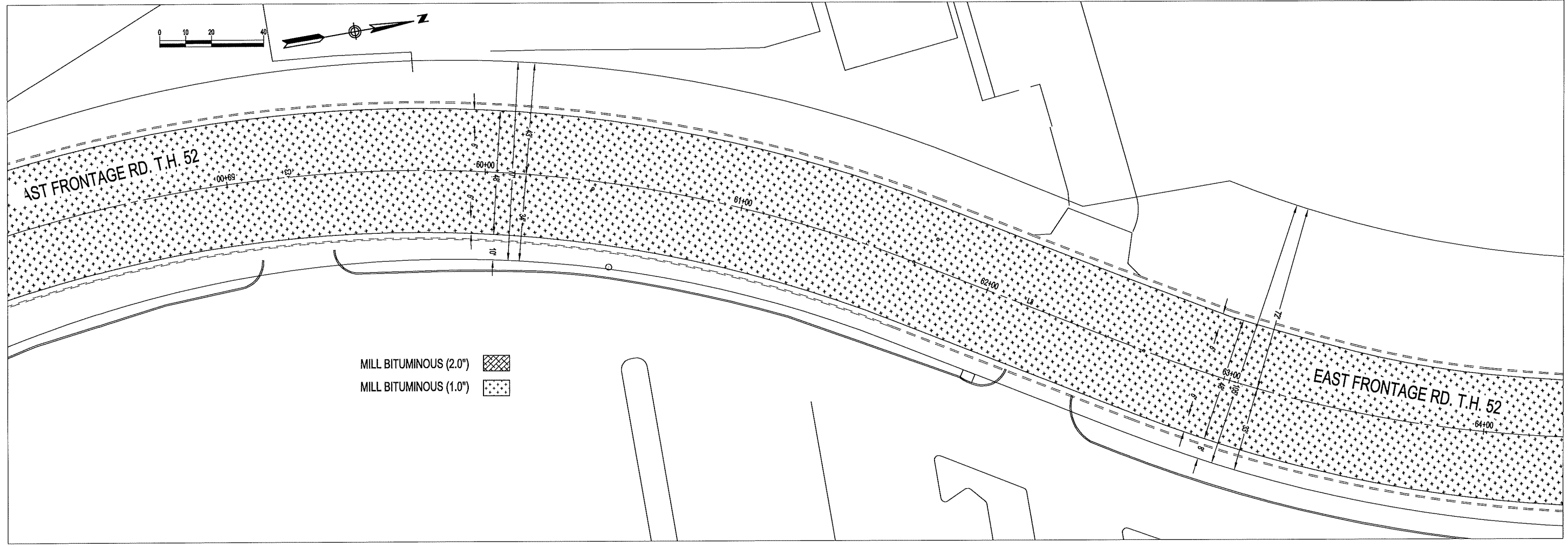
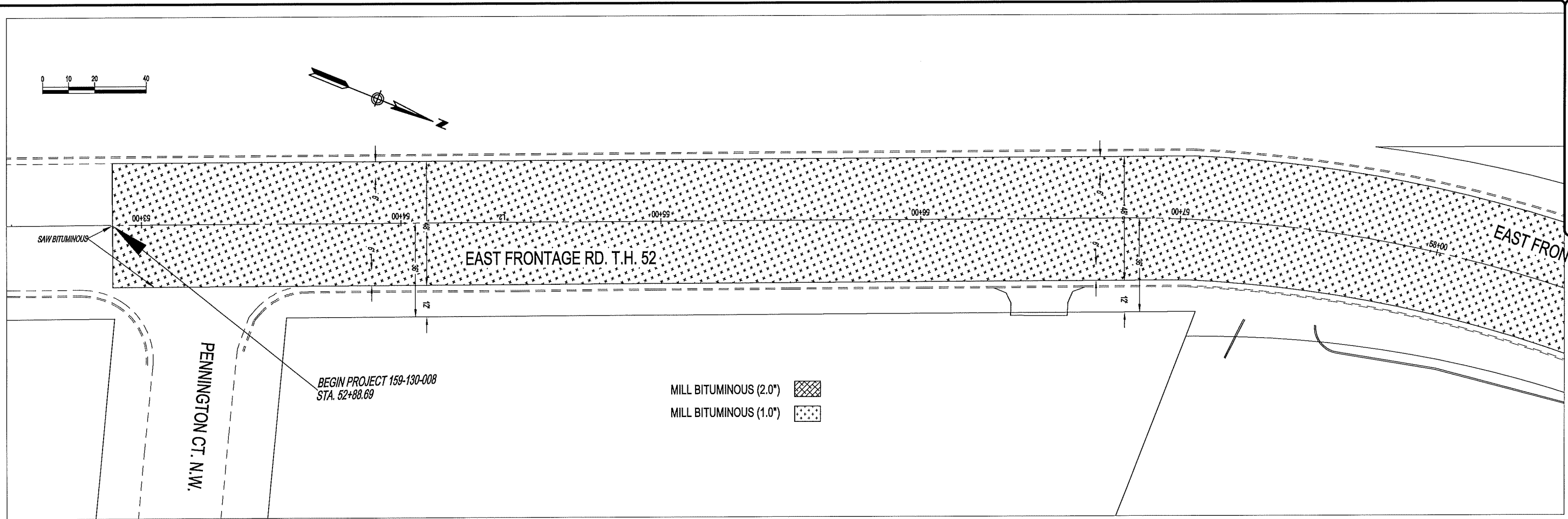

Revision comment: APPENDUM #1
 Revised: 5/30/17
 I hereby certify that this plan was prepared by me or under my direct supervision and that I am a duly Licensed Professional Engineer under the laws of the State of Minnesota.
Russell J. Khan
 Date: 4-24-17 Lic. No. 24667

201 4th Street S.E.
 Rochester, MN 55904
 www.rochestermn.gov/departments/publicworks
 Phone: (507) 228-2400 FAX: (507) 228-2401
Department of Public Works
 City of Rochester, Minnesota

REMOVALS
 ON EAST FRONTAGE RD. AND BANDEL RD. NW.
 FROM PENNINGTON CT. N.W. TO 5TH ST. N.W.

Designer: CWF
 Checker: RJK

S.A.P. No. 159-130-008
 City Job# J7322
 Sheet 4 of 19 Sheets

P:\PROJECTS\U-PROJ\U7322\Design\Drawings\7322R.dwg, REMOVALS-2, 5/30/2017 3:21:54 PM, cfeine, 1:2

